



# ***Assembly manual***

**for joined/ connected units**

***Connection on short side***



# ***Tools needed***

**For connecting/ joining the units**



**Spanner keys**



**Screw driver for cross head screws**



**Drill bit**



**Crowbar**

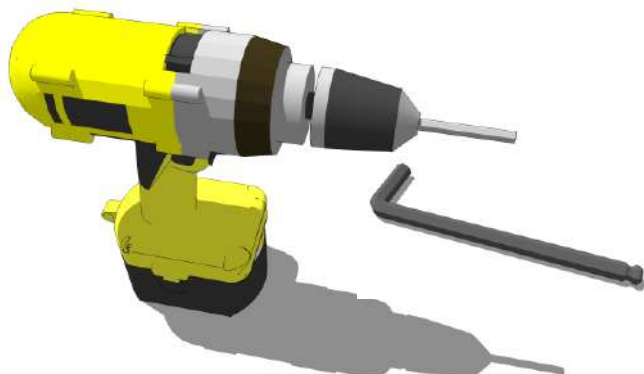

**High speed drill with 14mm allen key**



**Rubber Hammer**



**Rubber gloves**



1

2

3

4

5

6

7

8

# ***External*** ***Connection kit set***

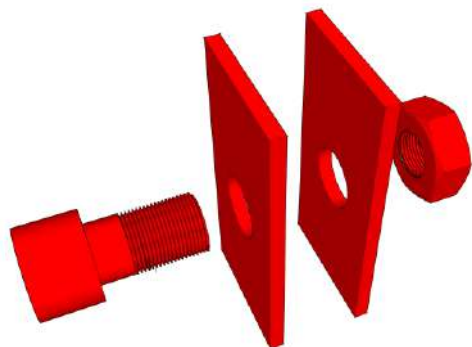

**Horizontal  
Connection plate**

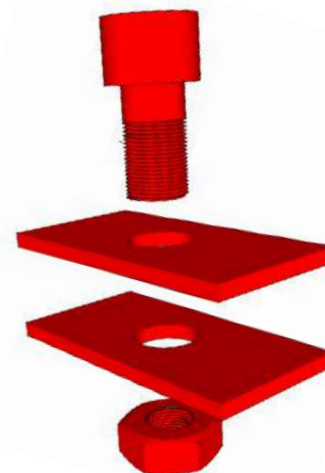

**Vertical  
Connection plate**

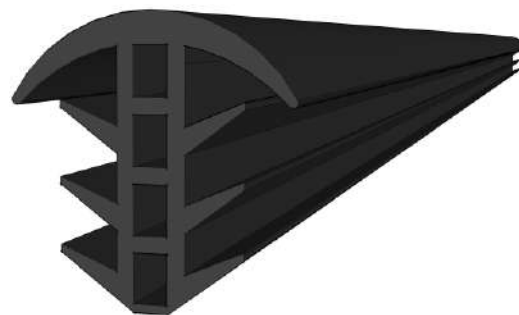

**Gasket/ sealing rubber**



1

2

3

4

5

6

7

**Internal**

**Connection kit set**

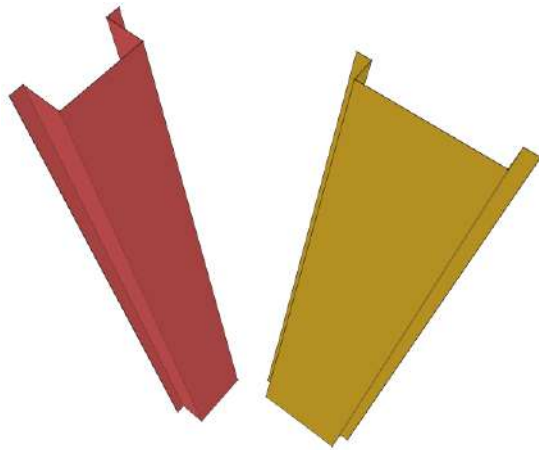

**Vertical flashings to cover  
corner posts connections/  
joints**

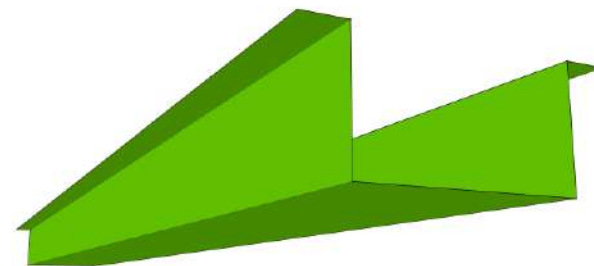

**Ceiling flashing to cover  
Roof frame connections/  
joints**



**Plywood strip  
floor filler**

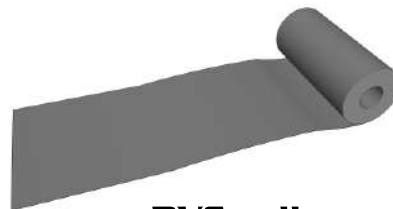

**PVC roll  
floor strip**

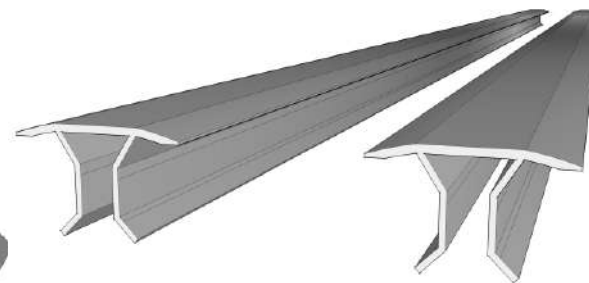

**Aluminum floor  
connector trim**



**Connection on *short side***

***External side***

**Position the flatpack containers in location. You can use a crowbar to adjust the alignment of the containers**

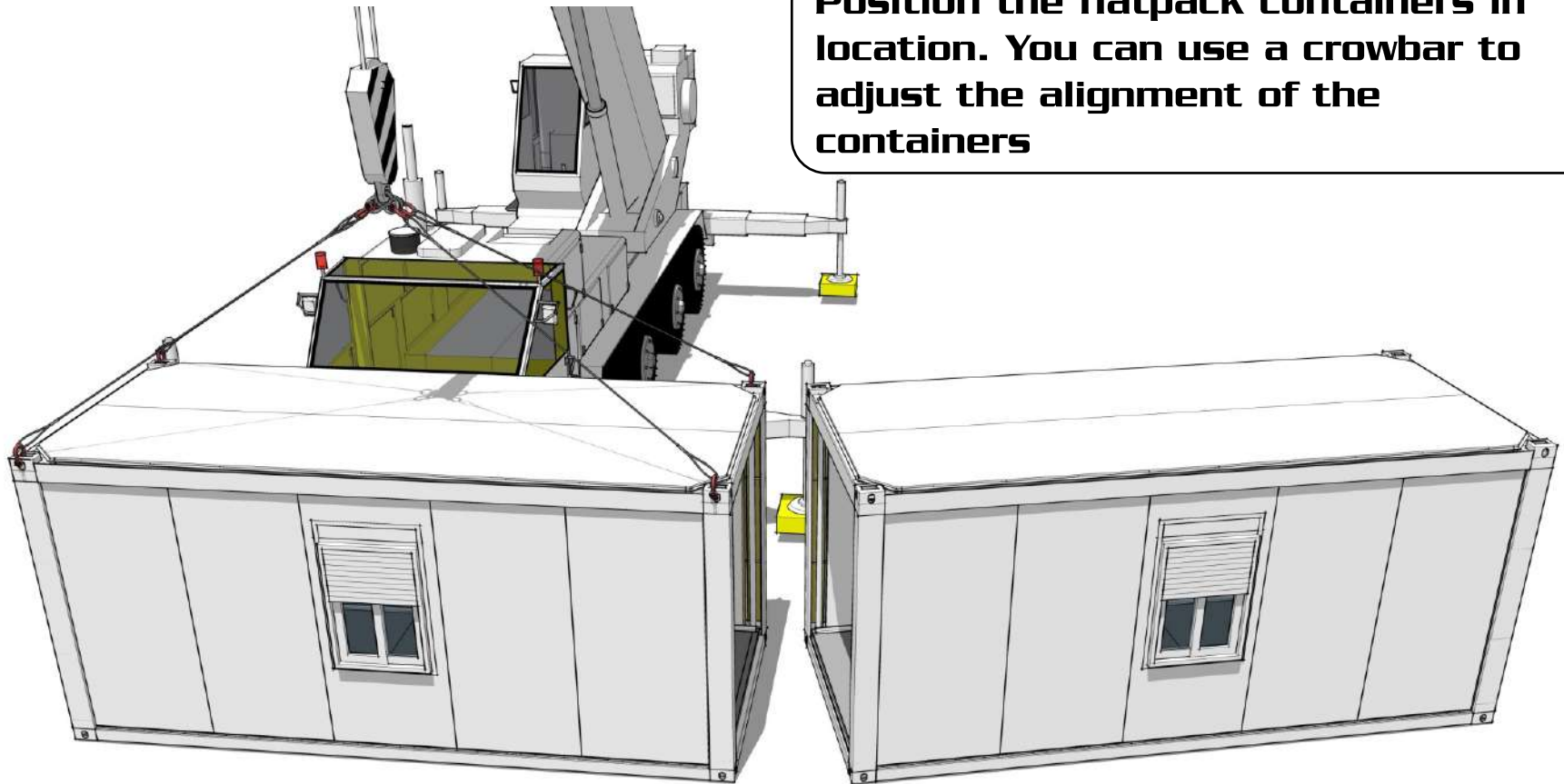

**Maintain a 12mm gap between  
flatpack containers**

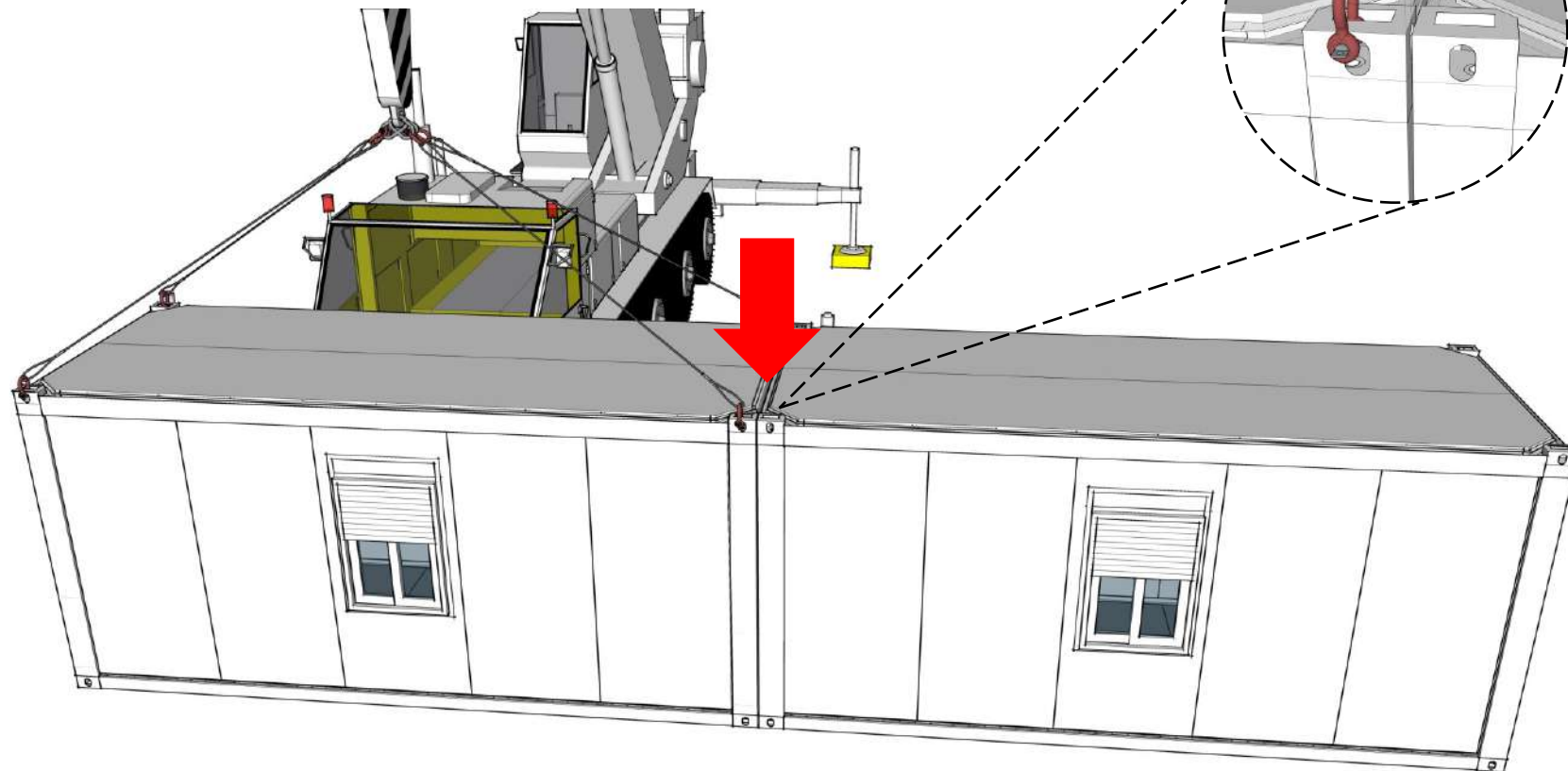



**Fix the connection plates on 4 corners.  
Do not make it tight at this stage.**

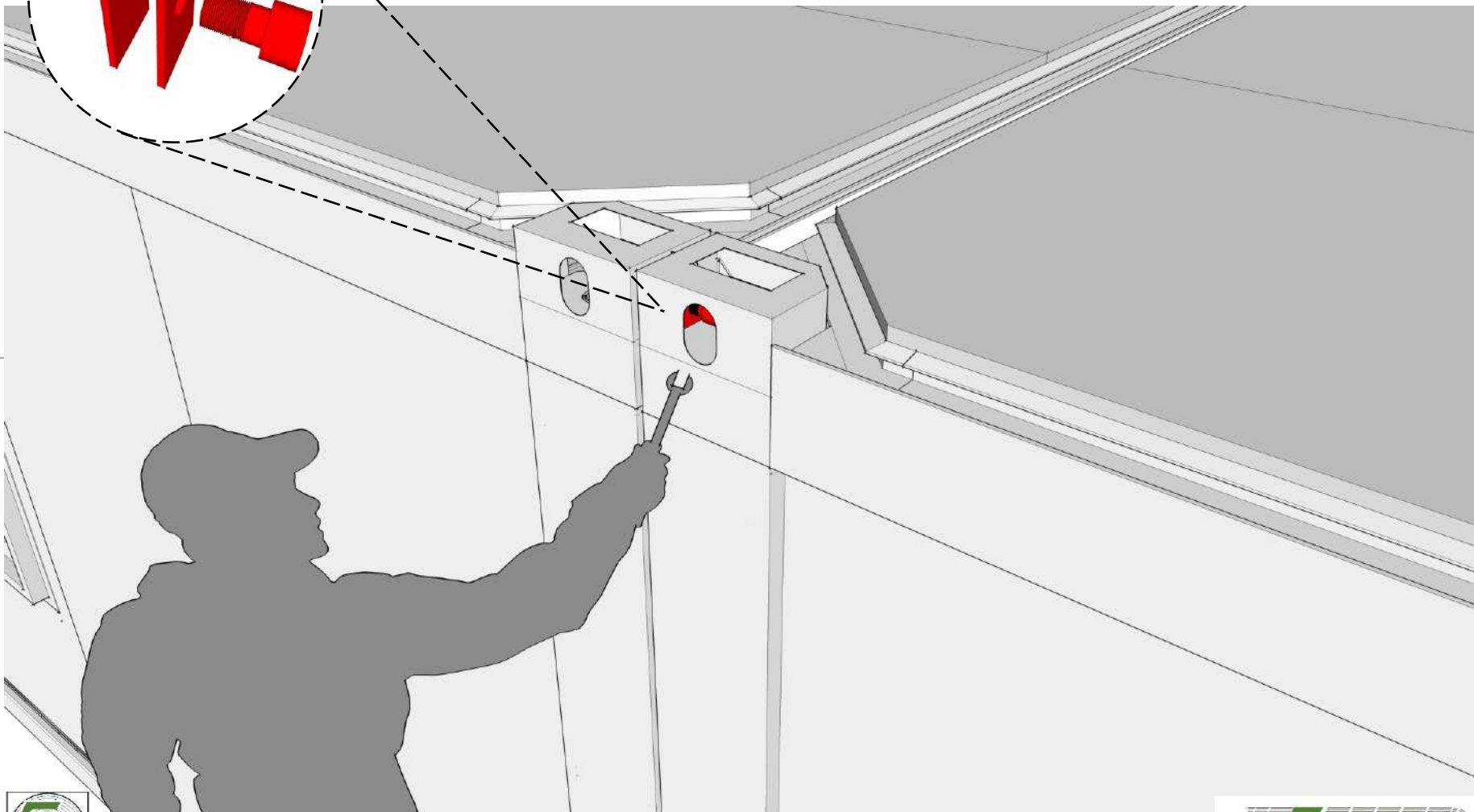
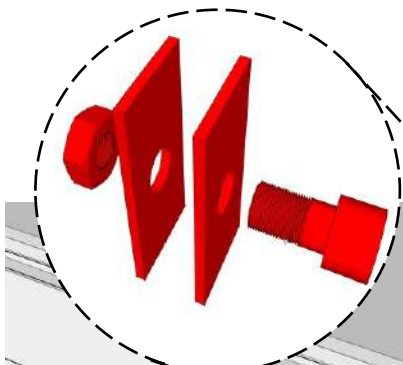

1

2

3

4

5

6

7

8

A

B

C

D

E

F

A

B

C

D

E

F

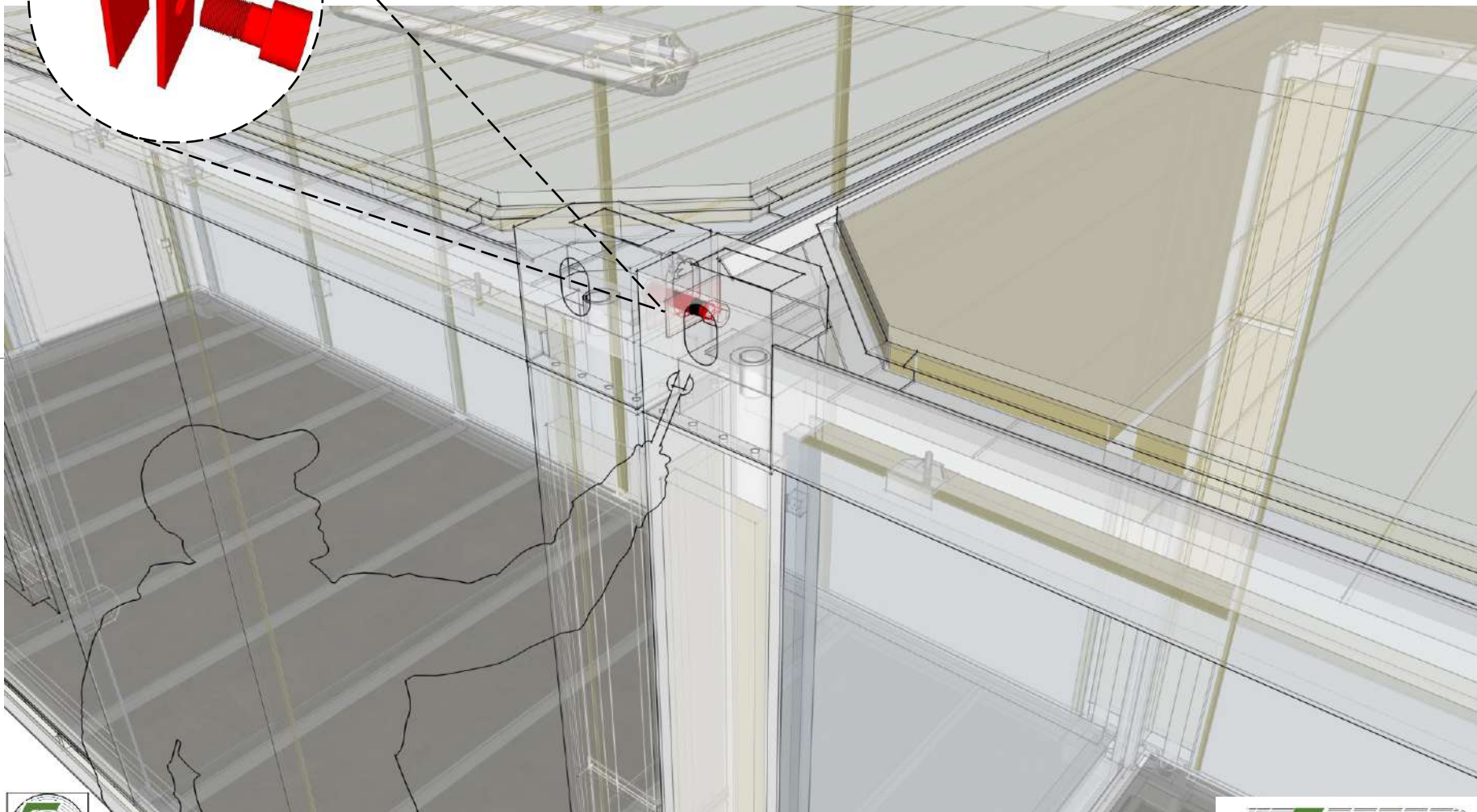

1

2

3

4

5

6

7



**2 sets at top corners and 2 sets at bottom corners. Do not make it tight.**

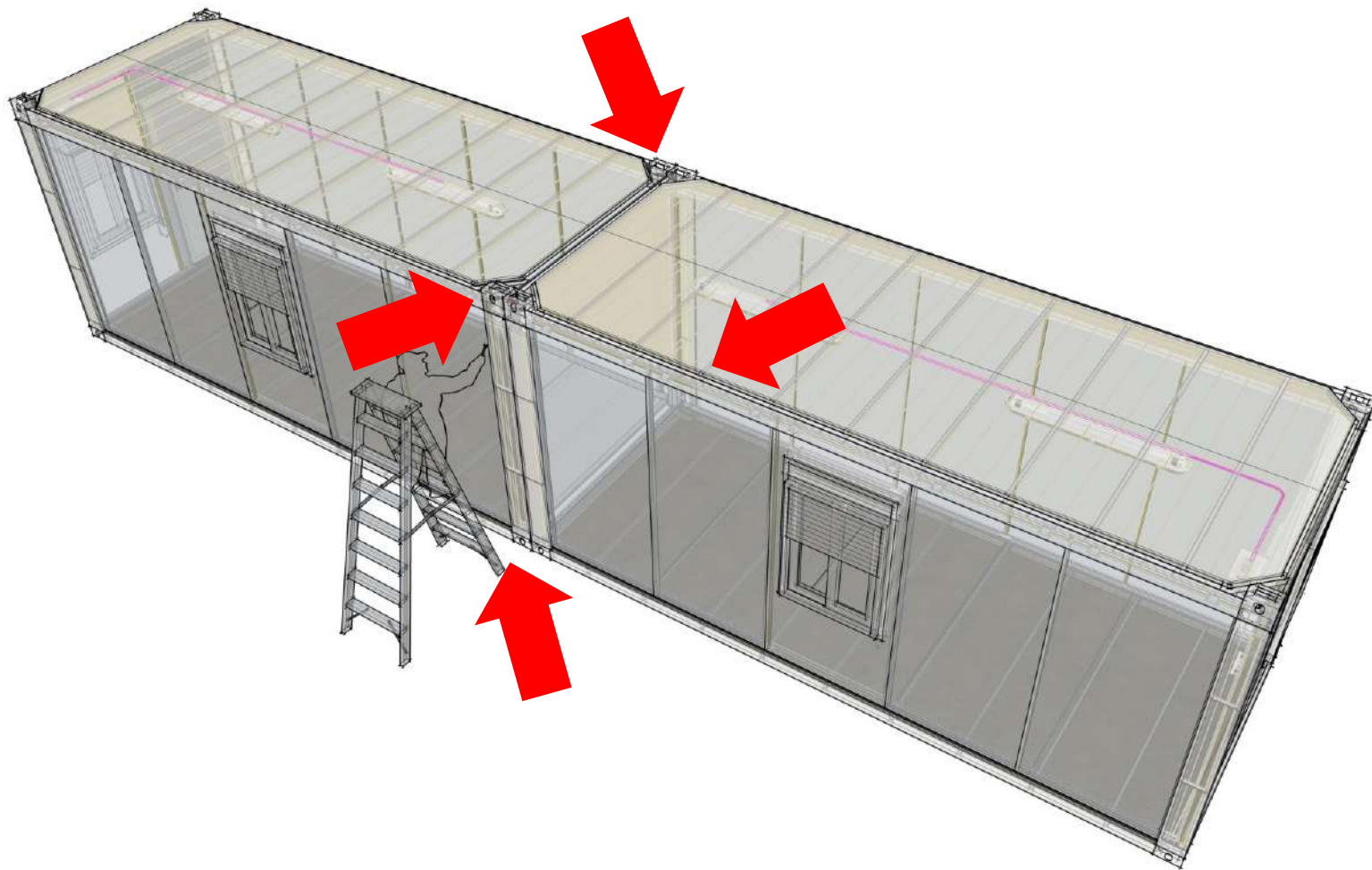

**Note:**

To avoid water leakage, use 1 pc 9m long sealing rubber all throughout the short side connection. No cut pieces.

**Install the sealing rubber all throughout the short side connection. Use rubber hammer to push the rubber in place.**

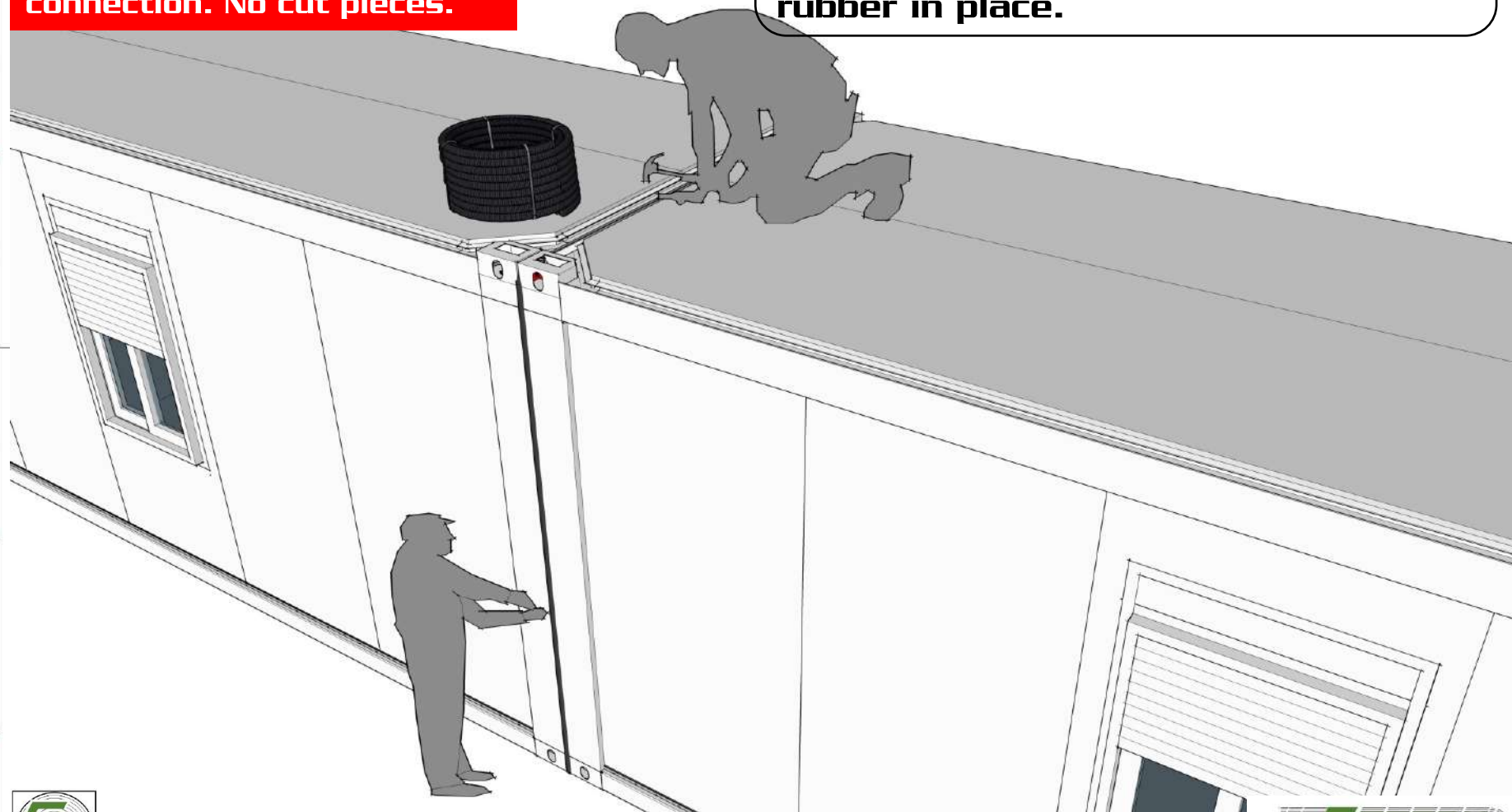

**Note:**  
Make sure sealing rubber  
goes around the top corner  
as shown below.

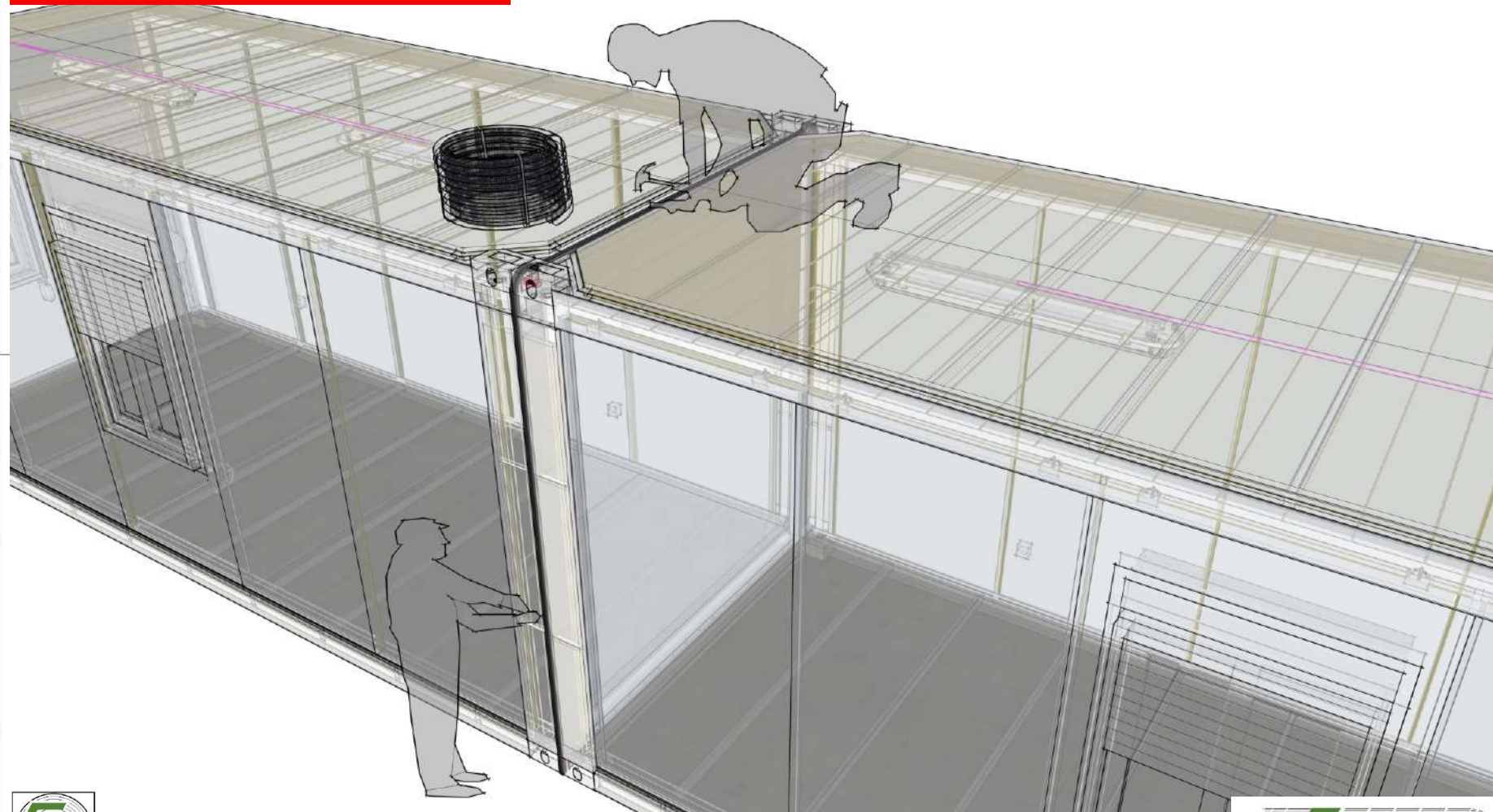



**After sealing rubber is installed. Tighten all connection plates. Ensure to maintain consistent gap during tightening all throughout to avoid twisting of frames.**

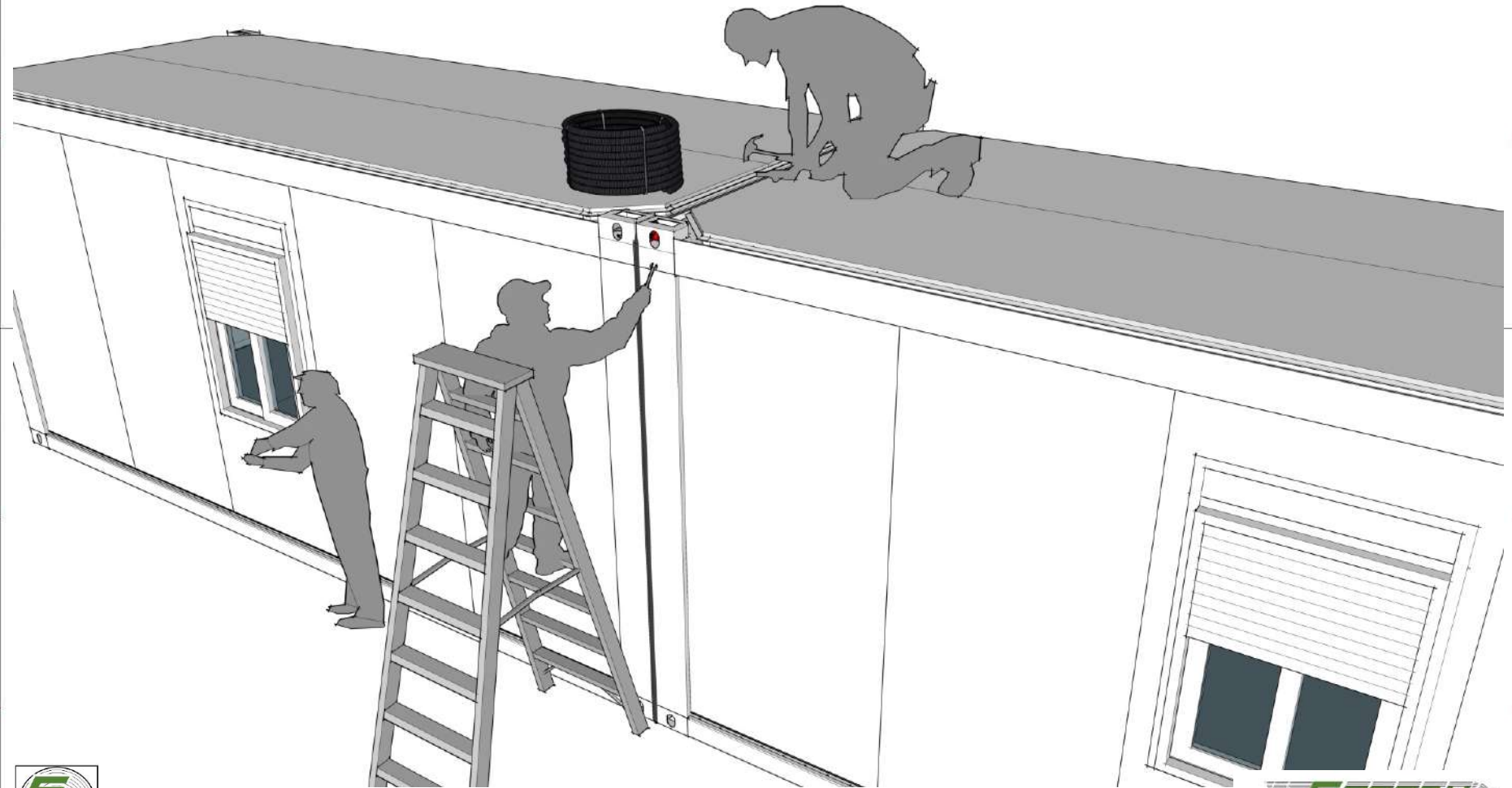

**SPEEDY  
HOUSE**

## Connection on *short side*

## *Internal side*

Install the plywood strip floor filler by screwing to floor frame. Center the plywood along the floor gap. There should be a sufficient gap between the plywood and the bump of the floor frame to install the aluminum floor connector trim.

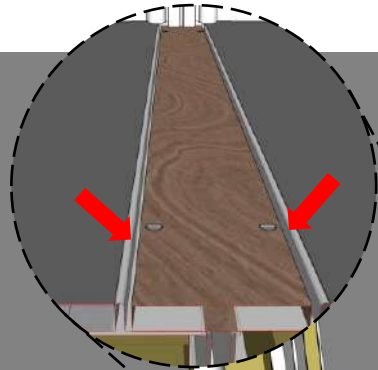



**Fix the PVC roll floor strip on the plywood strip by glue.**



**Install the Vertical flashing (cover inner post). Cut the top part to fit. Cutting can be done in the factory.**

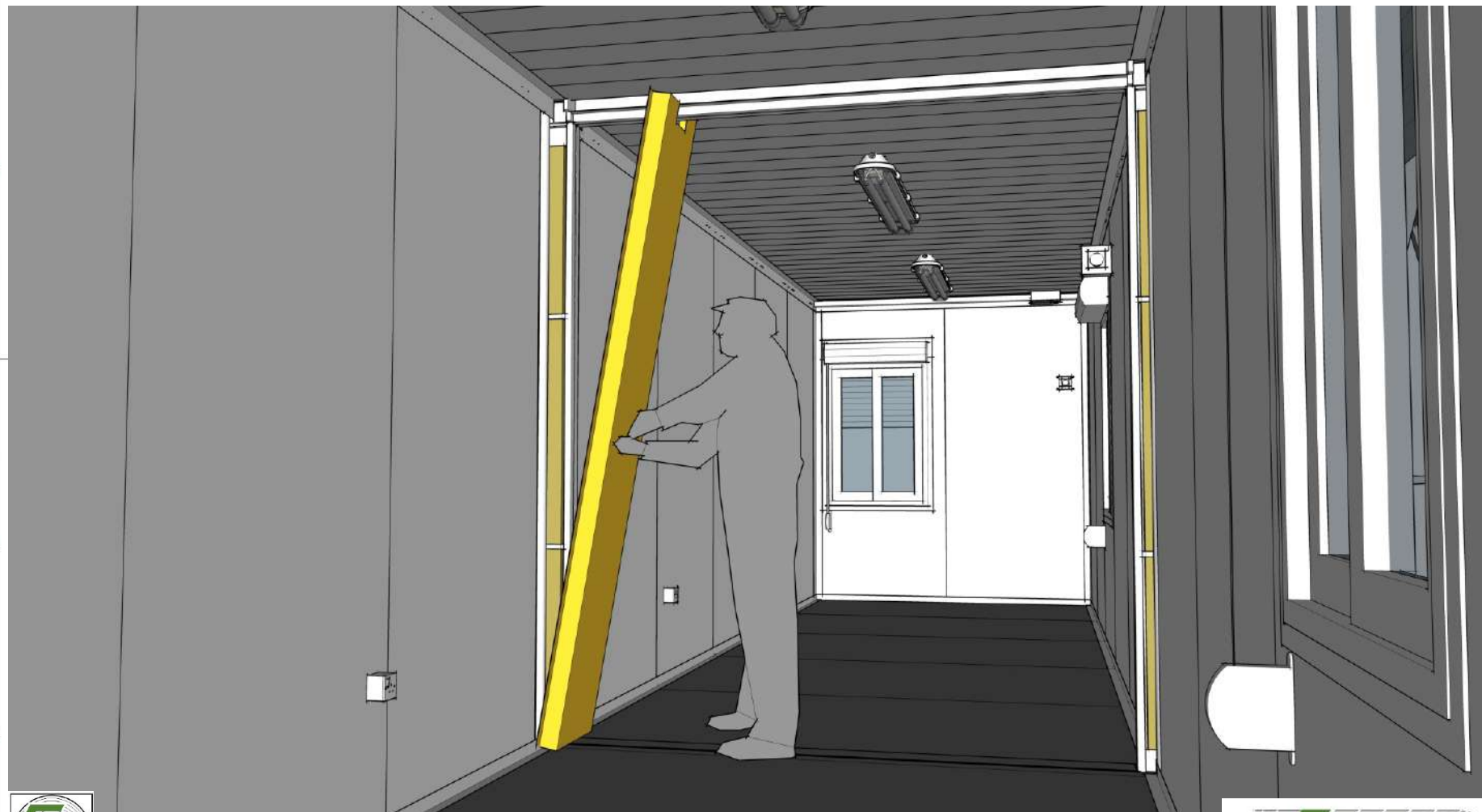

**Install the all vertical flashings in 1 time.**

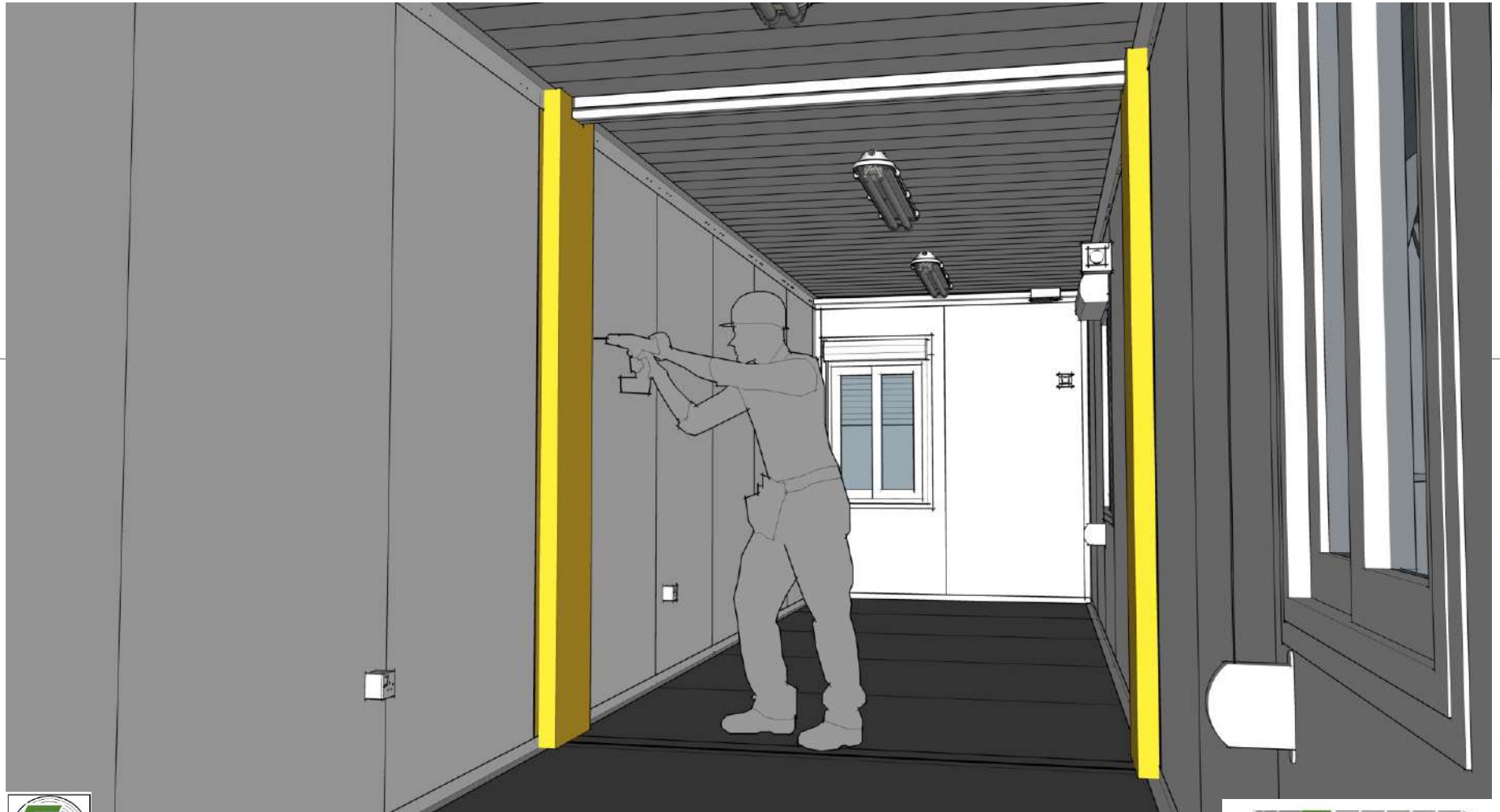

**Next, install ceiling flashing. Make sure to get the center before fixing it by screw.**



**Install the aluminum floor connector trim. These are fix without screws.  
Insert the groove into the**

**Push trim to the groove by  
using rubber hammer**

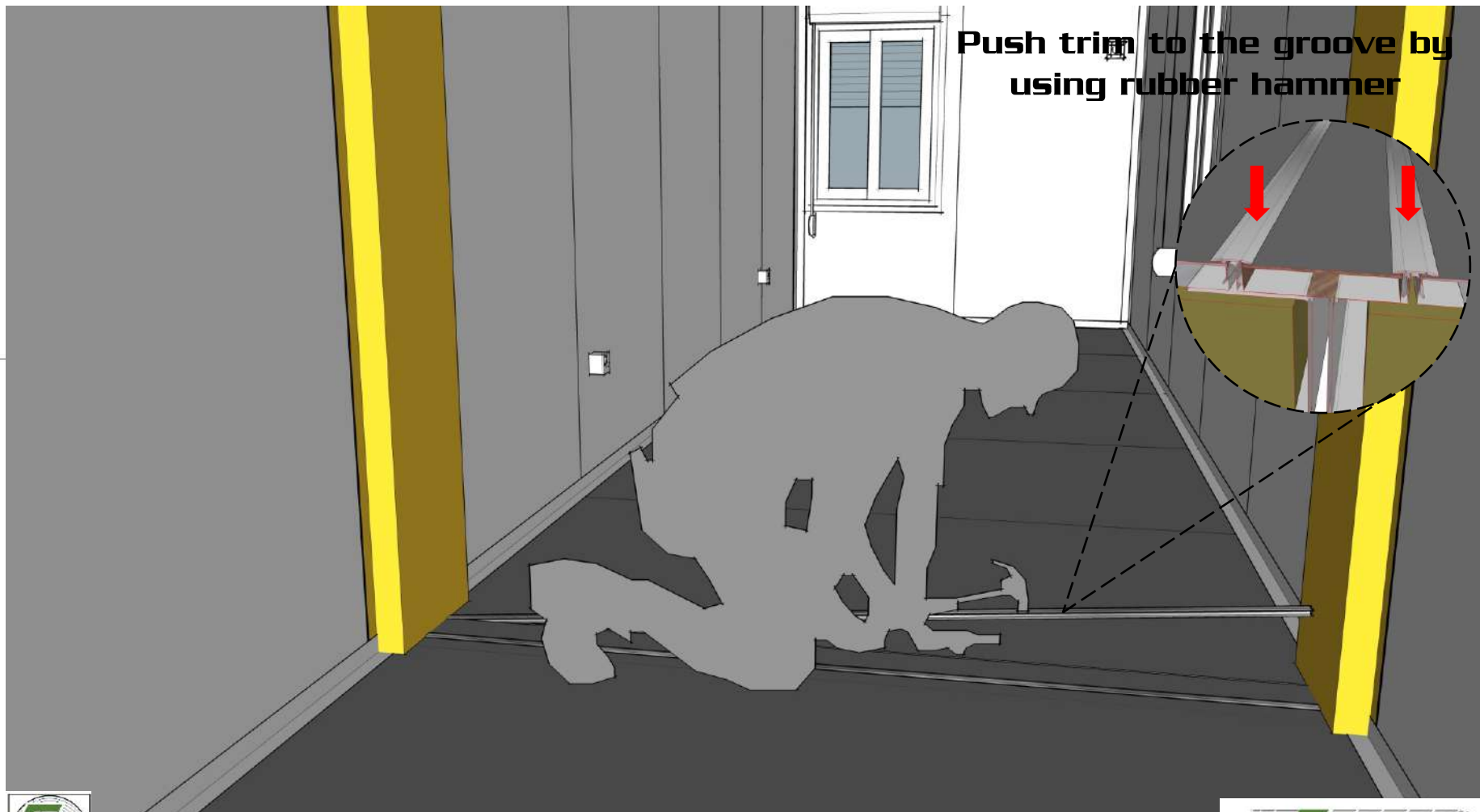



**Connection on *short side***

***External side***

**Sealing rubber/  
gasket**

**Connection  
plate set**

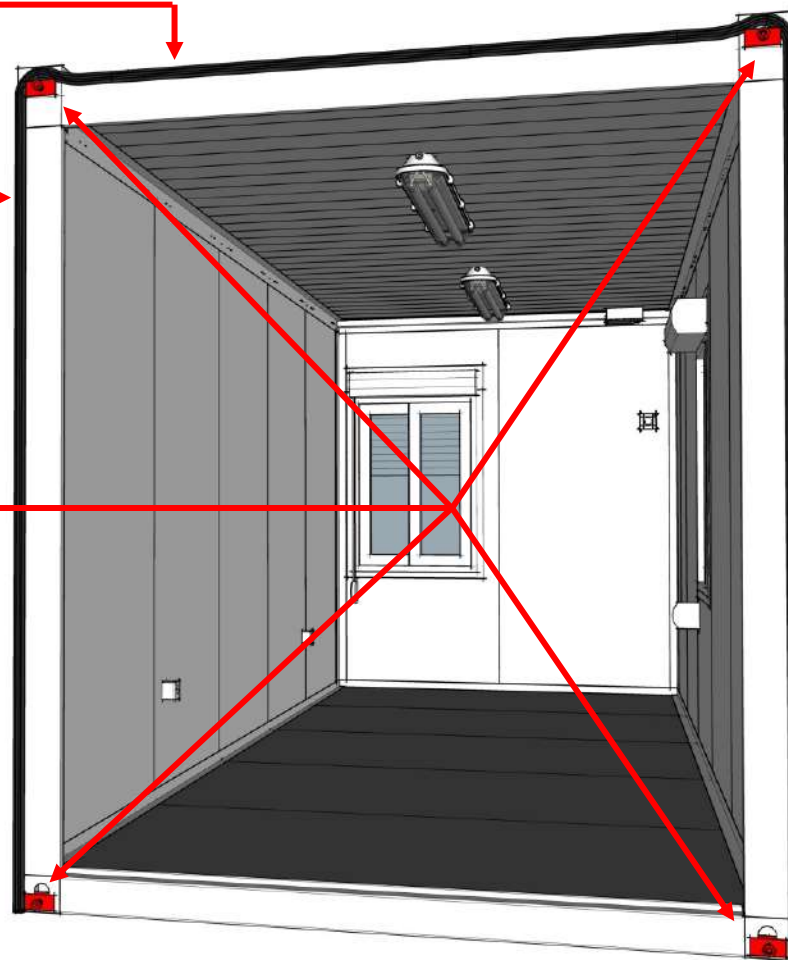

**SPEEDY  
HOUSE**

**Connection on *short side***

***Internal side***

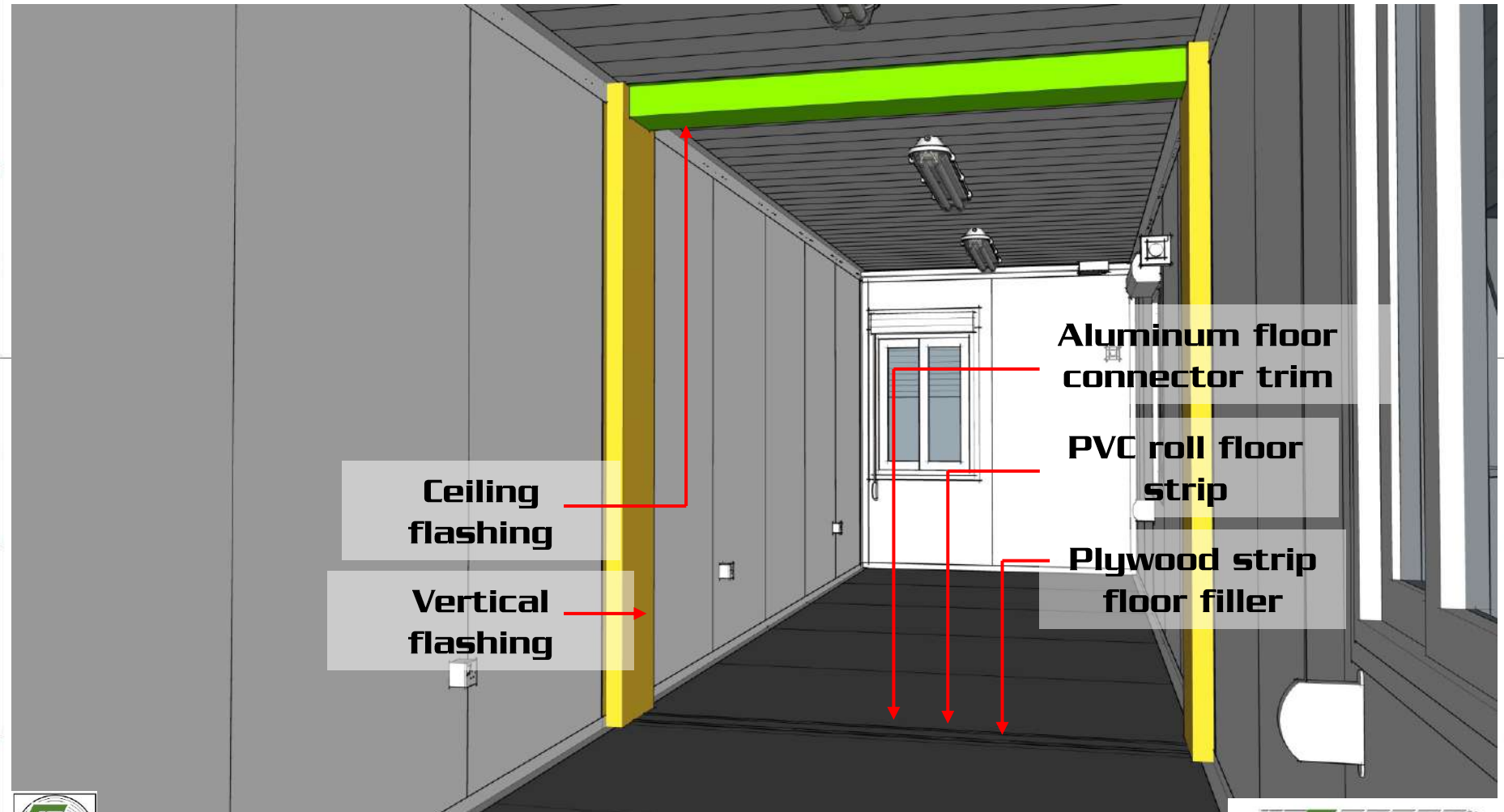

**Ceiling  
flashing**

**Vertical  
flashing**

**Aluminum floor  
connector trim**

**PVC roll floor  
strip**

**Plywood strip  
floor filler**



Lastly, install a rubber trim on all exposed **TOP** corner holes **ONLY**. This is to avoid overflowing on water on top corners in case of rain that will leave water stains on corner post paint.

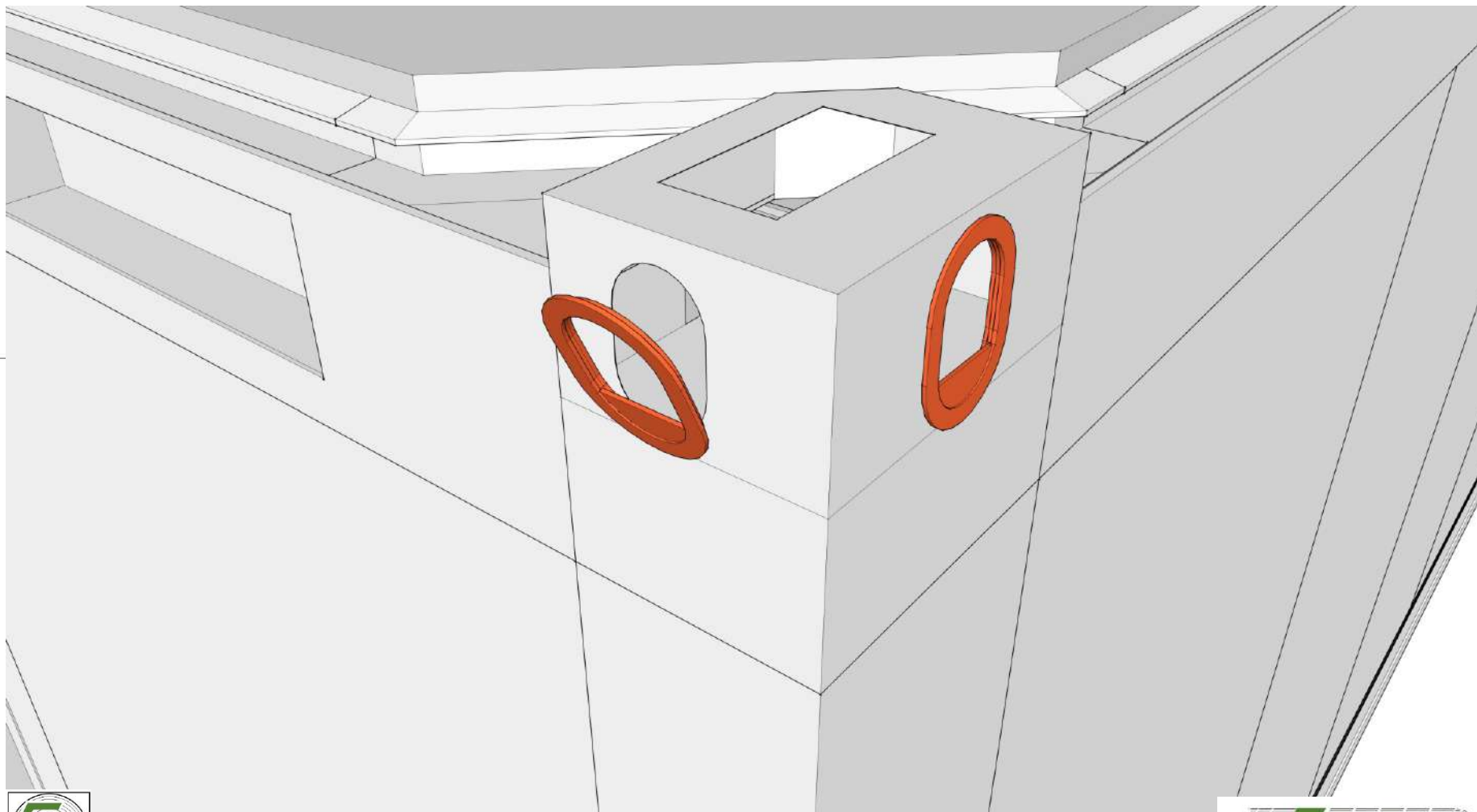

1

2

3

4

5

6

7

8

A

B

C

D

E

F

A

B

C

D

E

F

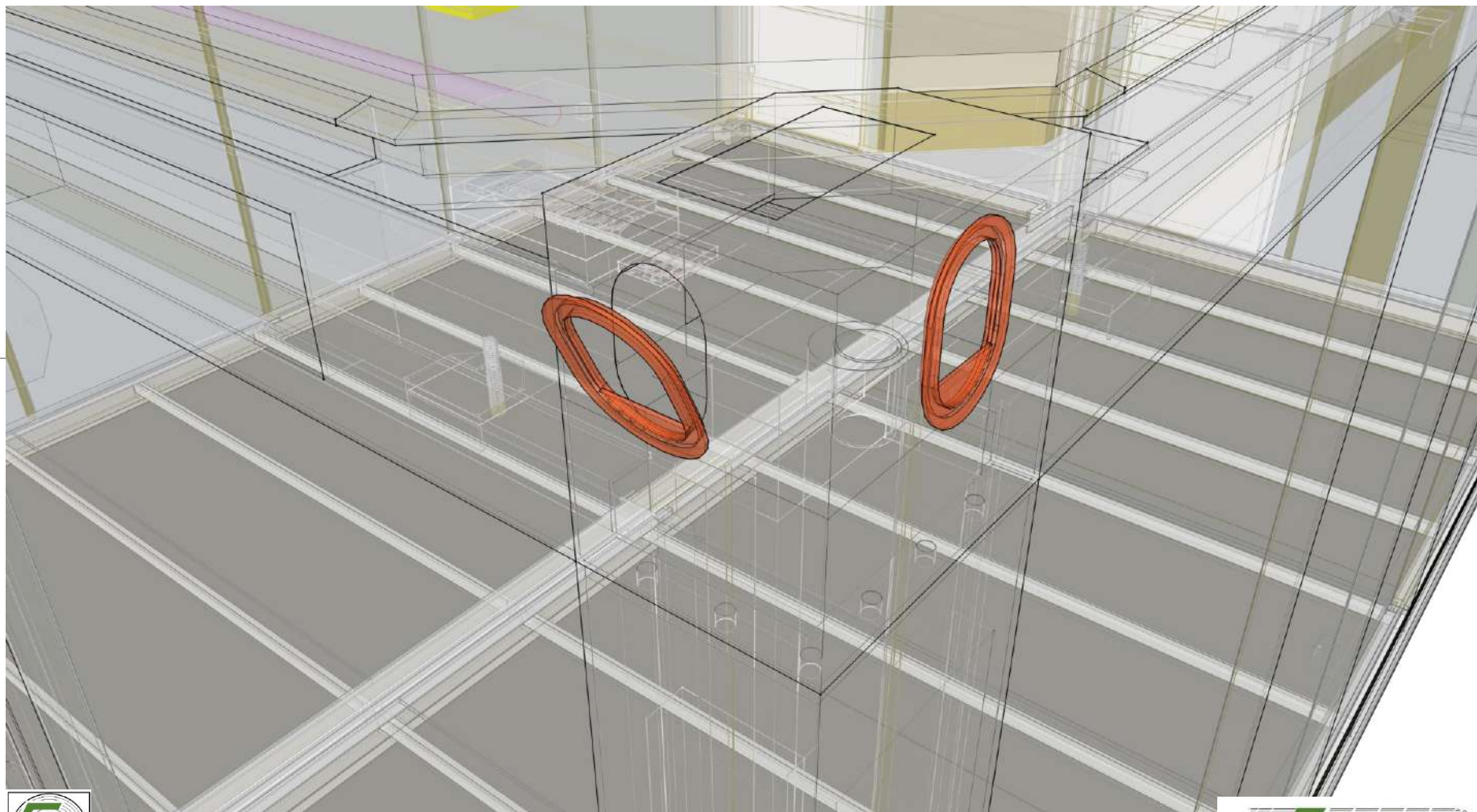



1

2

3

4

5

6

7

8

A

B

C

D

E

F

A

B

C

D

E

F



**SPEEDY  
HOUSE**



1

2

3

4

5

6

7

8

A

B

C

D

E

F

A

B

C

D

E

F

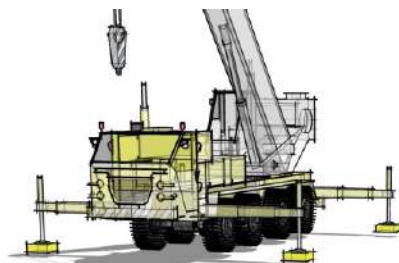

1

2

3

4

5

6

7

1

2

3

4

5

6

7

8

A

B

C

D

E

F

A

B

C

D

E

F

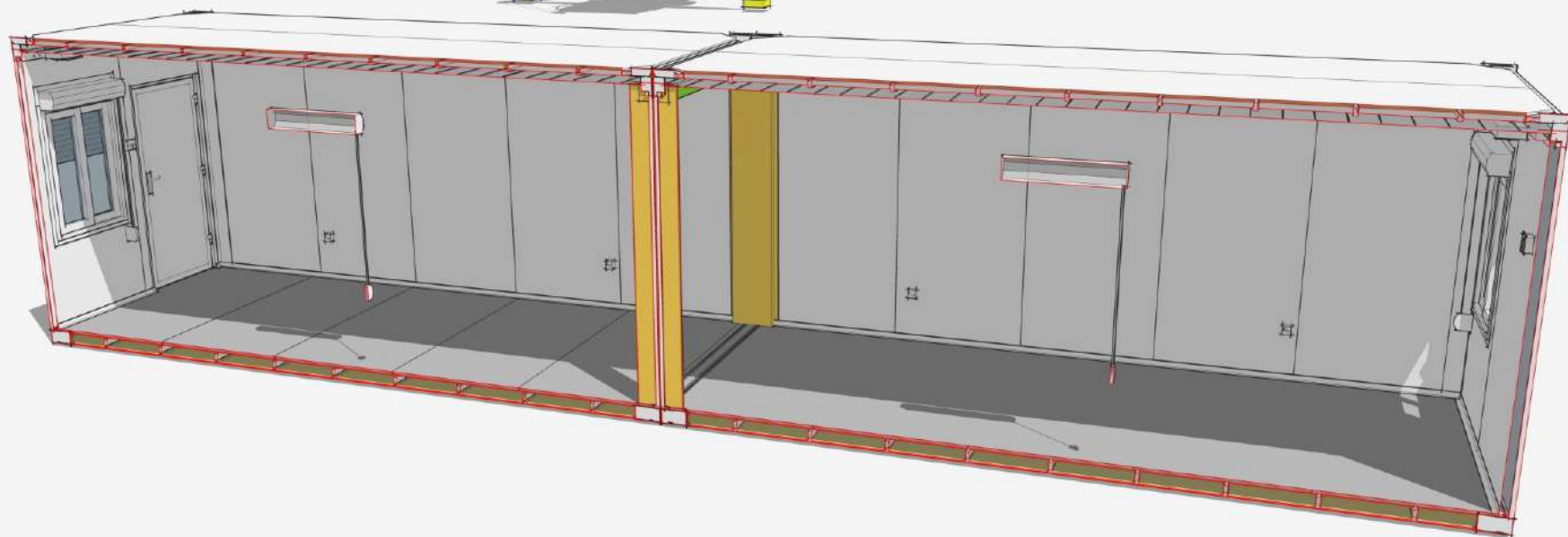

1

2

3

4

5

6

7